

# Assembly Sheet - SNOWMAX-Z2

1. Installation to be completed in accordance with manufacturer's written specifications and installation instructions.
2. See spec sheet or contact manufacturer for detailed material, finishes, and configuration options.
3. Contact manufacturer for detailed layout.
4. Do not scale drawings.
5. Subject to change without notice.
6. For patent information, visit our [Patent Page](#).

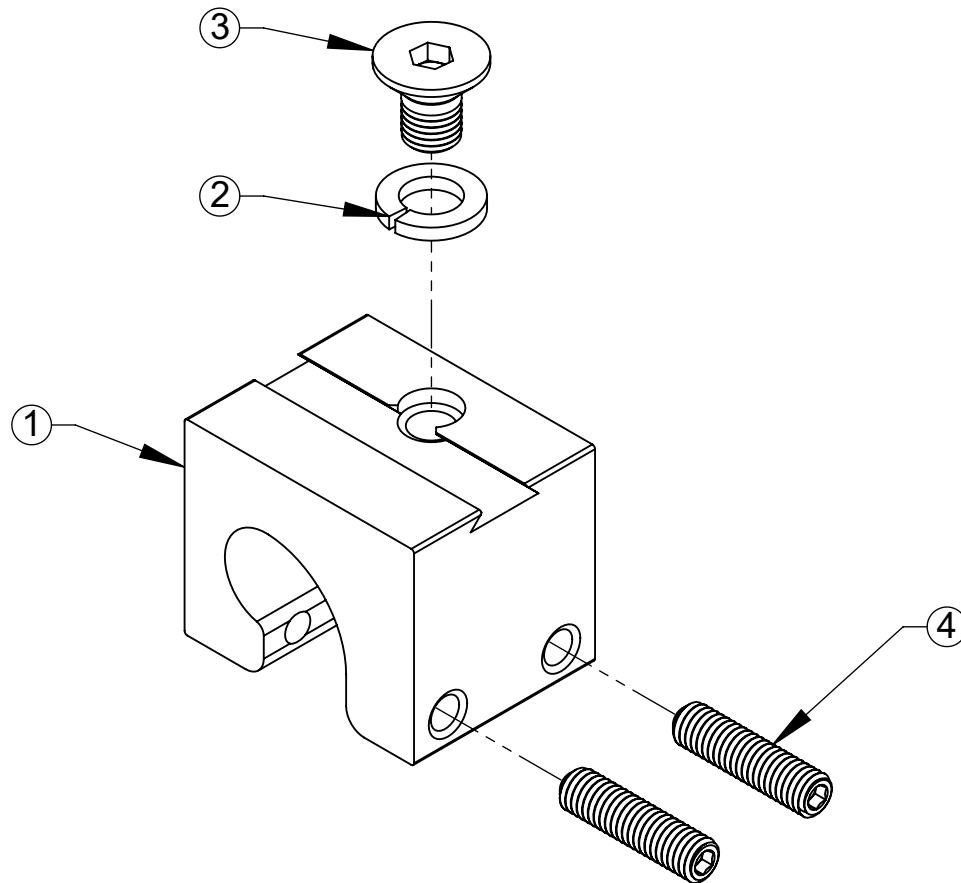

ITEM NO.	PART CODE	DESCRIPTION	QTY
1	SNOWMAX-Z2	SNOWMAX Z2 BLOCK 2"-AL	1
2	W-LOCK SS-.5	SS LOCK WASHER .5 ID (INCLUDED IN POLY KIT SM U2)	1
3	B-FLT SS-M12X1.75X25	SS FLAT HEAD BOLT M12X1.75X25 (INCLUDED IN POLY KIT SM U2)	1
4	SET-C SS-.375-16X1.5	SS CUP PT SET SCRW 3/8-16X1.5 (INCLUDED IN POLY KIT SET SCW 1.5)	2



289 Harrel Street  
Morrisville, VT 05661  
Phone: 1.888.766.4273  
Fax: 1.888.766.9994  
Email: [Info@alpinesnowguards.com](mailto:Info@alpinesnowguards.com)

Scale: 2:3

7/1/2022