



## **SnowMax - Corrugated Fence-Style Snow Guard Submittal Document Set**

### **ROOF TYPES**

- New / Existing Metal Batten or Snap
- New / Existing Metal Corrugated
- New / Existing Metal Ribbed

### **AVAILABLE MATERIALS**

- Aluminum 6000 Series (AL)

### **AVAILABLE FINISHES**

- Mill Finish
- Optional Color Insert Strip: Firestone Color Options

### **FEATURES/ADVANTAGES**

- Bracket (Block) employs our watertight, compression-fit technology
- Increased bracket spacing (up to 48" on center)
- Optional fixed position ice flags & color insert strips

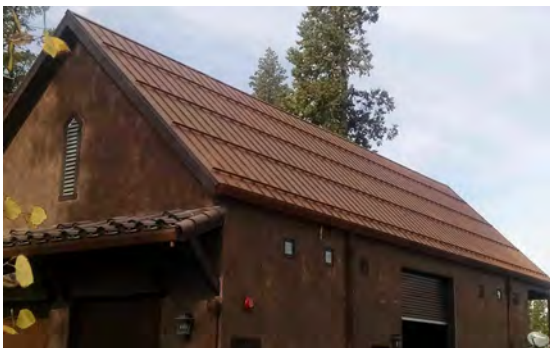

# Cut Sheet - SNOWMAX-CORRUGATED

1. Installation to be completed in accordance with manufacturer's written specifications and installation instructions.
2. See spec sheet or contact manufacturer for detailed material, finishes, and configuration options.
3. Contact manufacturer for detailed layout.
4. Do not scale drawings.
5. Subject to change without notice.
6. For patent information, visit our [Patent Page](#).

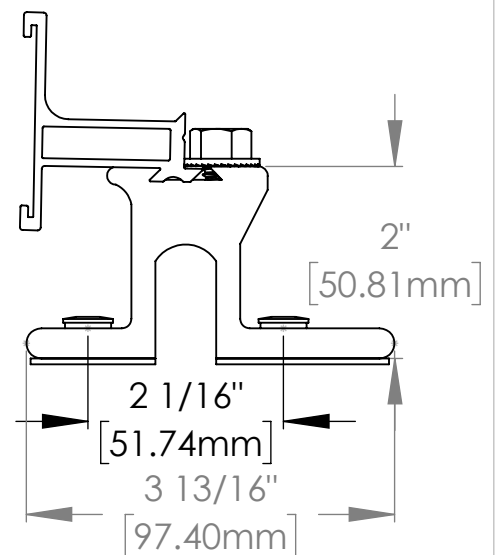
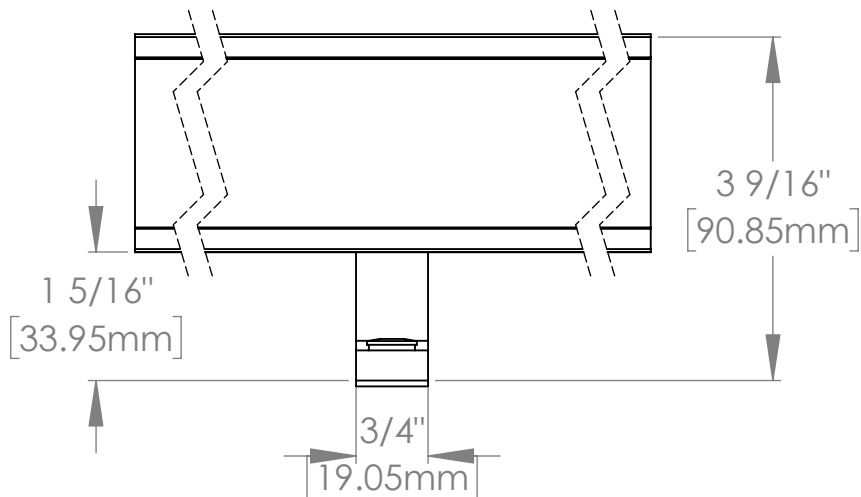
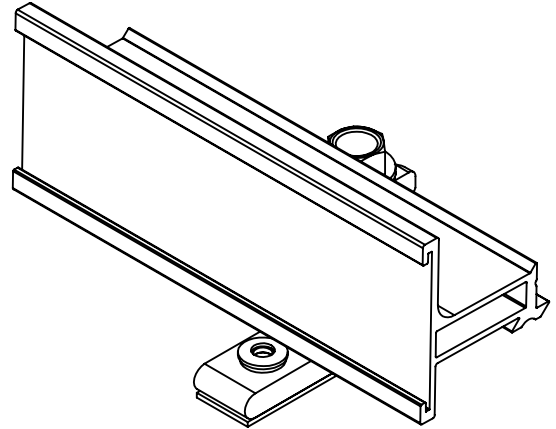
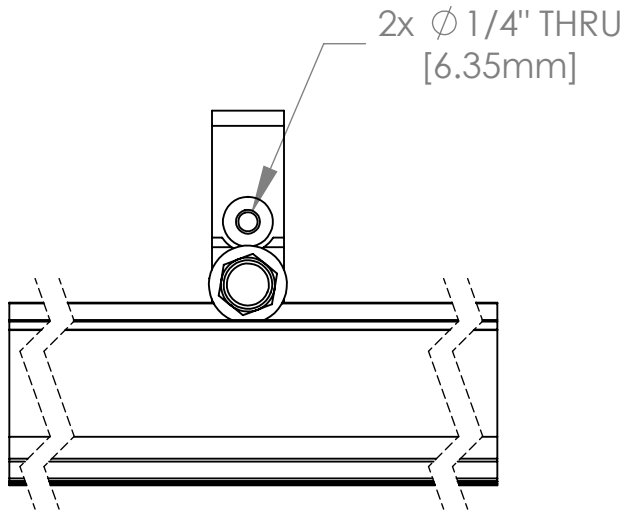

289 Harrel Street  
Morrisville, VT 05661  
Phone: 1.888.766.4273  
Fax: 1.888.766.9994  
Email: [Info@alpinesnowguards.com](mailto:Info@alpinesnowguards.com)

Scale: 1:2

2/16/2021

# Cut Sheet - SNOWMAX-IF

1. Installation to be completed in accordance with manufacturer's written specifications and installation instructions.
2. See spec sheet or contact manufacturer for detailed material, finishes, and configuration options.
3. Contact manufacturer for detailed layout.
4. Do not scale drawings.
5. Subject to change without notice.
6. For patent information, visit our [Patent Page](#).

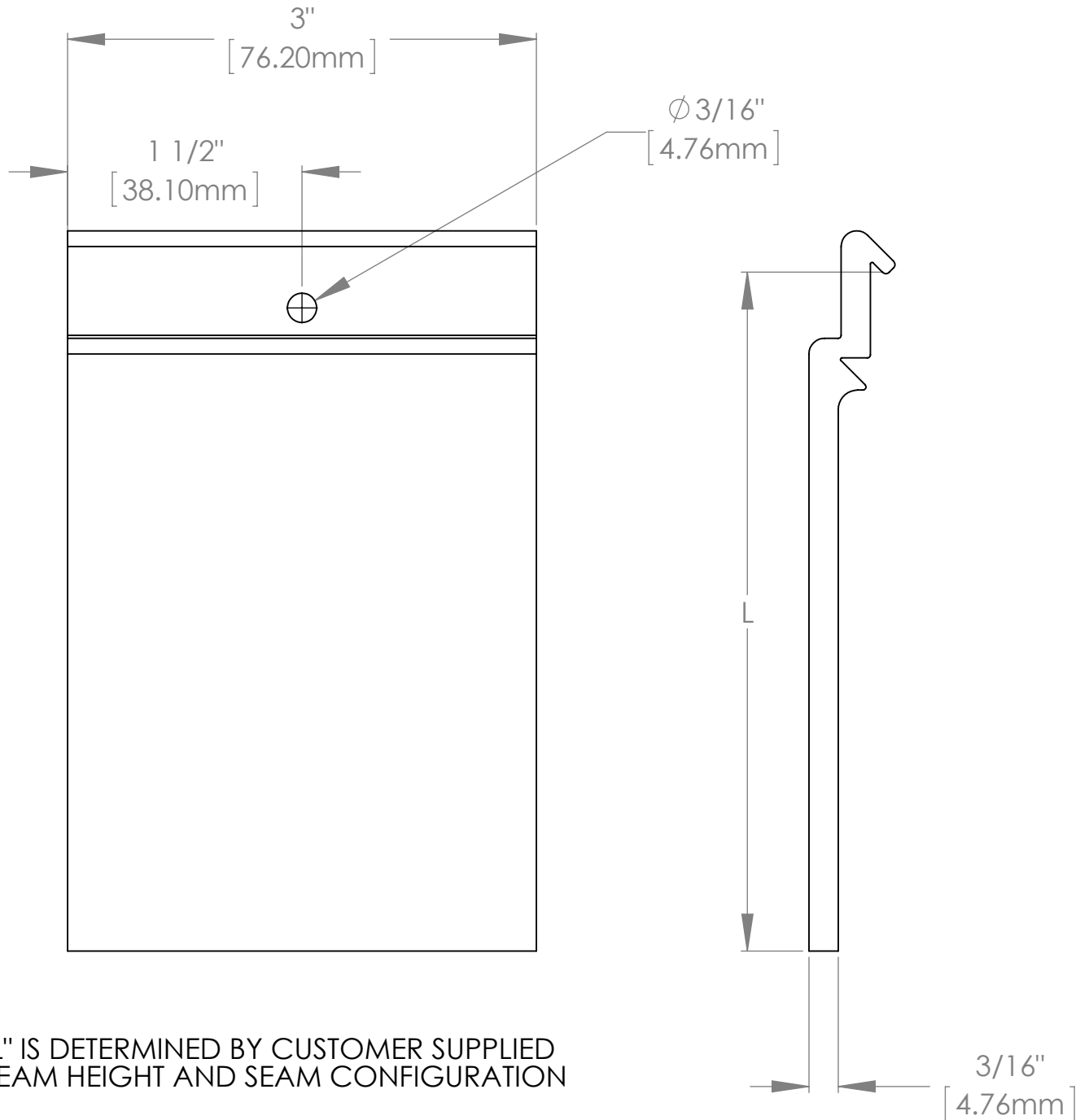

289 Harrel Street  
Morrisville, VT 05661  
Phone: 1.888.766.4273  
Fax: 1.888.766.9994  
Email: [Info@alpinesnowguards.com](mailto:Info@alpinesnowguards.com)

Scale: 1:1

6/12/2019

# Cut Sheet - SNOWMAX-LITE-BAR

1. Installation to be completed in accordance with manufacturer's written specifications and installation instructions.
2. See spec sheet or contact manufacturer for detailed material, finishes, and configuration options.
3. Contact manufacturer for detailed layout.
4. Do not scale drawings.
5. Subject to change without notice.
6. For patent information, visit our [Patent Page](#).

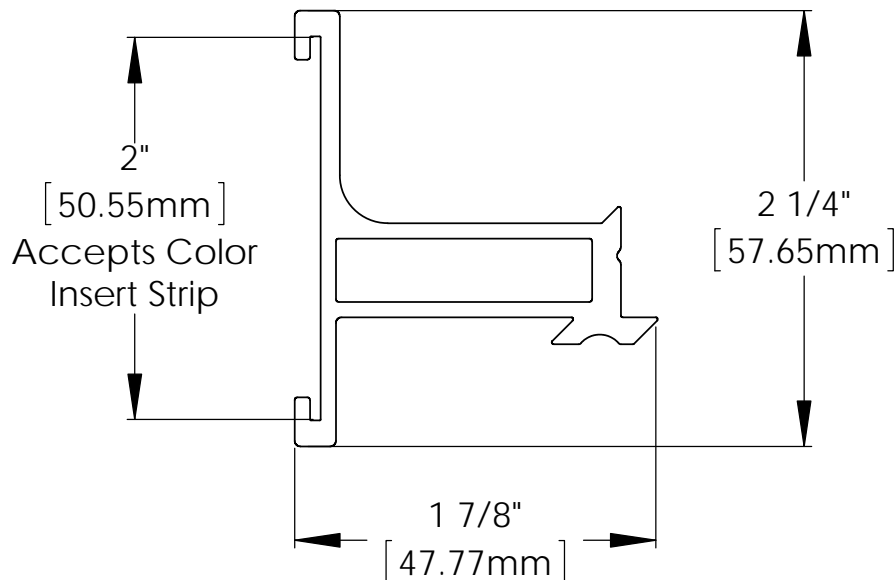
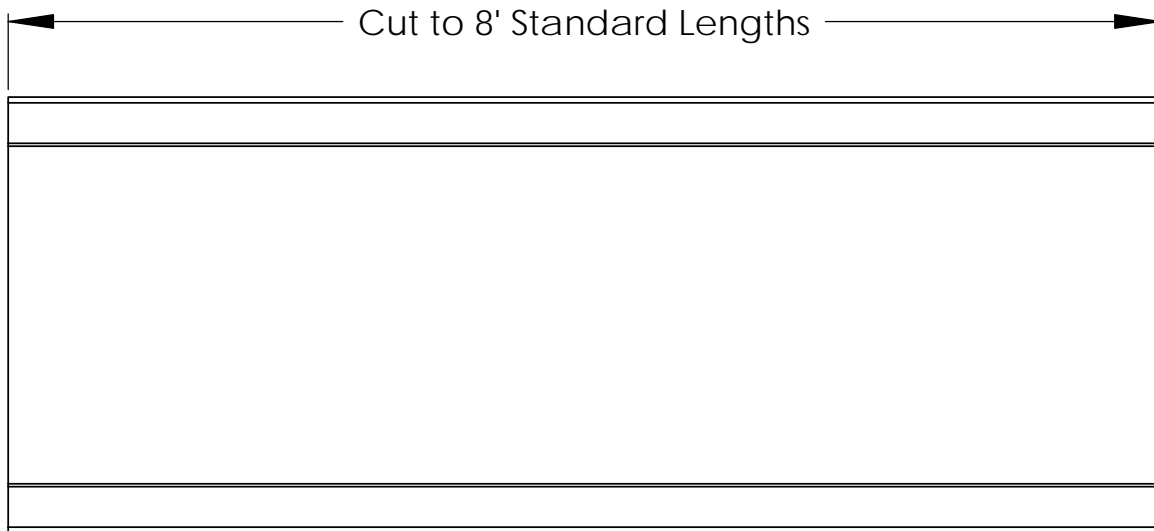

289 Harrel Street  
Morrisville, VT 05661  
Phone: 1.888.766.4273  
Fax: 1.888.766.9994  
Email: [Info@alpinesnowguards.com](mailto:Info@alpinesnowguards.com)

Scale: 1:1

8/26/2019

# Assembly Sheet - SNOWMAX-CORRUGATED

1. Installation to be completed in accordance with manufacturer's written specifications and installation instructions.
2. See spec sheet or contact manufacturer for detailed material, finishes, and configuration options.
3. Contact manufacturer for detailed layout.
4. Do not scale drawings.
5. Subject to change without notice.
6. For patent information, visit our [Patent Page](#).

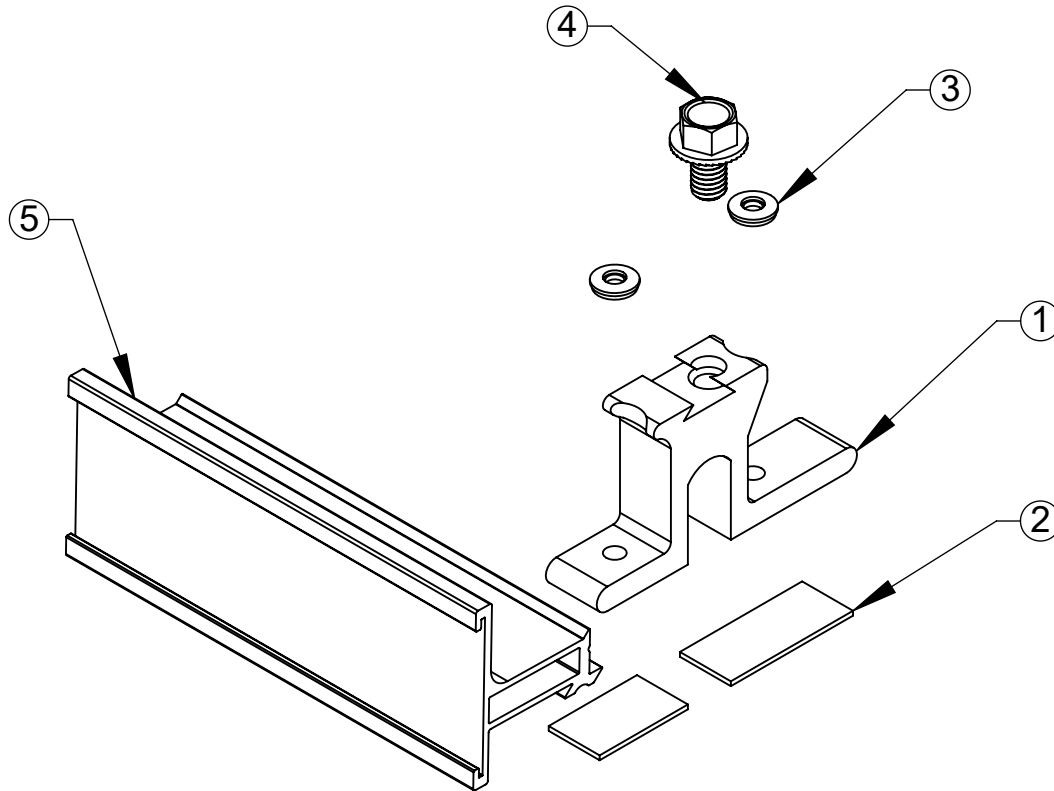

ITEM NO.	PART CODE	DESCRIPTION	QTY
1	SNOWMAX-CORRUGATED	SNOWMAX CORRUGATED BRACKET-AL	1
2	BUTYL TAPE	BUTYL TAPE (PRE-INSTALLED ON BRACKET)	2
3	W-NEO SS-.25	SS NEO WASHER .25 ID	2
4	B-FL SS-.375-16X.562	SS FLANGE BOLT .375-16X.5625	1
5	SNOWMAX-LITE-BAR	SNOWMAX LITE BAR 2"-AL (8' LENGTHS)	AS NEEDED



289 Harrel Street  
 Morrisville, VT 05661  
 Phone: 1.888.766.4273  
 Fax: 1.888.766.9994  
 Email: [Info@alpinesnowguards.com](mailto:Info@alpinesnowguards.com)

Scale: 1:2

8/25/2022



## **SnowMax - Corrugated Fence-Style Snow Guard Specification Sheet**

### **PART 1 – GENERAL**

#### **1.1 SUMMARY**

##### **A. WORK INCLUDES**

1. SnowMax-Corrugated snow guard that attaches through corrugated roofing directly to roof sub-structure.
2. Coordinate with installation of roof to assure proper placement of snow guards.
3. Provide appropriate fasteners for roof system.

##### **B. RELATED SECTIONS**

- |  |                            |
|--|----------------------------|
| 1. Section 076000: Flashing and Sheet Metal. | MasterFormat 2016 07 60 00 |
| 2. Section 074100: Roofing/ Siding panels.   | MasterFormat 2016 07 50 00 |
| 3. Section 077253: Snow Guard.               | MasterFormat 2016 07 50 00 |
| 4. Section 076100: Sheet Metal Roofing.      | MasterFormat 2016 07 50 00 |

#### **1.2 SYSTEM DESCRIPTION**

##### **A. COMPONENTS**

Bracket: An aluminum bracket with butyl tape, dovetail shape channel, and two fastener holes with neoprene bonded washers.

1. SNOWMAX-CORRUGATED
2. (2) W-NEO SS-.25
3. BUTYL TAPE

Bar: An aluminum bar (8' length) that attaches to mounting bracket via dovetail and flange bolt. It contains a 2" tall slot for an optional color insert strip.

4. B-FL SS-.375-16X.562
5. SNOWMAX-LITE-BAR

- a. SNOWMAX-LIGHT SPLICE (included with bar)

Fasteners:

1. To be of metal compatible with snow guards.
2. Fasteners should be selected for compatibility with roof structure.
3. Fastener strength should exceed or be equal to that of snow guard system.

##### **B. ACCESSORIES**

1. SNOWMAX-IF, Ice Flags, optional
2. SNOWMAX-CI, Color Insert, optional

##### **C. DESIGN REQUIREMENTS:**

1. Spacing to be recommended by manufacturer or building engineer.
2. Install a minimum of 2 fasteners per mounting bracket.
3. It is important to design new structures or assess existing structures to make sure they can withstand retained snow loads.

#### **1.3 SUBMITTAL**

- A. Submit manufacturer's specifications, standard detail drawings, installation instructions, and recommended layout.

#### **1.4 QUALITY ASSURANCE**

- A. Installer to be experienced in installation of specified roofing material and snow guards for not less than 5 years in the area of the project.



## **SnowMax - Corrugated Fence-Style Snow Guard Specification Sheet**

### **1.5 DELIVERY / STORAGE / HANDLING**

- A. Inspect material upon delivery and order replacements for any missing or defective items. Keep material dry, covered and off the ground until installed.

## **PART 2 – PRODUCTS**

### **2.1 MANUFACTURER**

- A. Designed and exclusively distributed by Alpine SnowGuards®, a Division of Vermont Slate & Copper Services, Inc.  
289 Harrel St., Morrisville, VT 05661 | 888-766-4273 | [www.alpinesnowguards.com](http://www.alpinesnowguards.com)

### **2.2 MATERIALS**

1. SNOWMAX-CORRUGATED – 6000 Series Aluminum
2. W-NEO SS-.25 – Stainless Steel and Neoprene
3. Butyl Tape
4. B-FL SS- .375-16X.562 – 304 stainless steel 18.8 alloy
5. SNOWMAX-LITE-BAR – 6000 Series Aluminum
6. SNOWMAX-LIGHT SPLICE – 6000 Series Aluminum
6. SNOWMAX-CI – .032 Aluminum
7. SNOWMAX-IF – 6000 Series Aluminum

### **2.3 FINISH (choose one)**

- A. Mill Finish – standard
- B. Kynar 500® pre-painted coil – (SNOWMAX-CI only)

## **PART 3 – EXECUTION**

### **3.1 EXAMINATION**

- A. Substrate
  1. Inspect structure on which the brackets are to be installed and verify that it will withstand any additional loading that it may incur. Notify general contractor of any deficiencies before installing Alpine SnowGuards' products.
  2. Verify that roofing material has been installed correctly prior to installing snow guards.

### **3.2 INSTALLATION**

- A. Comply with architectural drawings and snow guard manufacturer's recommendations for location of system. Comply with manufacturer's written installation instructions for installation and layout.

Document Version 05.25.2023  
07 72 53 Snow Guards



## SnowMax - Corrugated Snow Guard Installation Instructions

### ROOF TYPES

- New / Existing Metal Batten or Snap
- New / Existing Metal Corrugated or Ribbed

**Note:** *SnowMax-Corrugated bracket must be installed on a roof surface with solid decking or structure beneath roofing material to create a proper seal. This system should not be installed on roof surfaces that have compressible insulation between roofing material and roof substructure.*

### INSTALLATION

1. Remove film from butyl tape located on bottom of bracket.  
Place bracket on roof surface above a supporting structural component.
2. Using proper fasteners for project (consult with fastener manufacturer or project engineer), insert fasteners through bonded washers so the EPDM surface will engage top of bracket and stainless-steel surface is facing up.
3. Fasten to roof using two holes on bracket. Torque fasteners until bracket is pulled down snug to roof surface. When EPDM seal on bonded washer begins to compress out of the sides of the washer, the system is tight. The torque required will vary with the project, roof deck age and type. Be sure not to over torque fasteners and strip threads.

Use fig. 1 as a visual guide for correct torque.

fig. 1

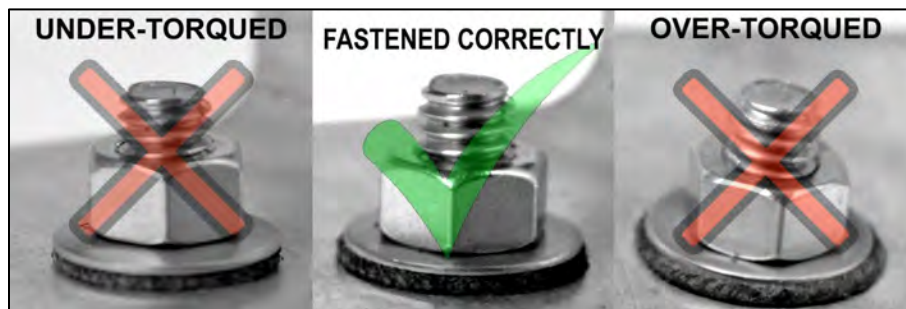

**Note:** *Metal roofs expand and contract due to thermal change. As a result, exposed fasteners sometimes move. Although it is not required, sealing perimeter of bracket using an acceptable sealant, such as clear silicone, is acceptable.*

4. Place SNOWMAX-LITE-BAR into bracket's dovetail feature.
5. Install flange bolt into tapped hole on bracket, located behind bar. Tighten until bolt bottoms-out and bar is secure. (This will be a tight fit to the back vertical part of the bar).





## **SnowMax - Corrugated Snow Guard Installation Instructions**

### **SNOW GUARD ACCESSORIES (OPTIONAL)**

#### **SnowMax-Color Insert**

The face of the bar is designed to accept a 2" wide color insert. This is available in a limited color selection from Alpine SnowGuards. Many installers provide this part themselves using roofing material they have on hand.

#### **SnowMax-Ice Flag-AL**

- Ice flags are optional but recommended, at least on bottom tier of guards (assuming project needs more than one tier).
- Ice Flags are cut to length so flag does not rest on panel.
- To install, center Ice Flag between brackets and fasten with one Tek screw (provided).
- For brackets spaced 25" wide or wider, install two Ice Flags between brackets, spaced evenly.

**Note:** Once point of TEK screw is through metal, only tighten enough to engage TEK screw. Do not over-tighten or over-torque with a drill. Tighten by hand only to securely engage flag.

### **SNOW GUARD LAYOUT FOR BAR/PIPE STYLE BRACKETS**

- Contact Alpine SnowGuards for detailed layout.
- Do not install runs of snow retention bar more than 100 feet long without a break to allow for thermal expansion.
- First row of snow guards is installed above outer most wall or support of the building.

Document version 07.02.2024  
07 72 53 Snow Guards



## **Snow Guard Maintenance**

Our snow guards must be inspected annually. Any defects or damage in materials and/or workmanship must be reported to Alpine SnowGuards immediately. Seller will not be responsible for snow guard systems that have not been properly maintained.

- Ensure snow guard brackets, accessories & components are intact, have not been displaced, and show no signs of damage or wear.
- Inspect fasteners into roof deck.
- Inspect snow guard-related waterproofing and replace or repair where necessary to ensure roof integrity.
- Snow accumulation on roofs and rooftop solar panels must be removed to avoid damage to the roof or panels, the building structure, and anything below. Heavy snowfalls, drifting, and the gradual accumulation of snow and ice can lead to less-than-ideal snow guard performance.
- Check each clamp set screw with a torque wrench to ensure proper fastening has been maintained (clamp-to-seam models).
- Inspect sealant, tape, and adhesive. Remove and replace as needed.

Document Version 04.15.24

## Pre-Painted Kynar® Stock Colors Pad Style Snow Guards and SnowMax Color Insert Strips



UNA-CLAD™ METAL  
COLOR SELECTION

### Double-Sided Stock Colors



Colonial Red (51)



Classic Copper (75)

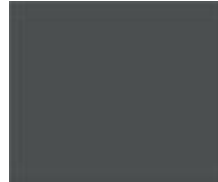

Charcoal Gray (05)



Slate Gray (03)



Matte Black (69)

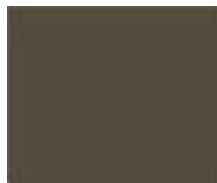

Medium Bronze (66)

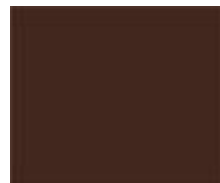

Mansard Brown (81)

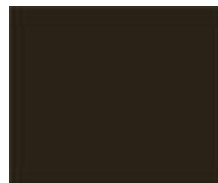

Dark Bronze (57)



Hartford Green (33)

### Single-Sided Stock Colors

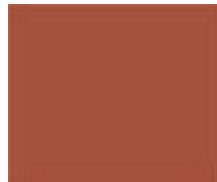

Terra Cotta (54)



Patina Green (39)



Hemlock Green (36)



Teal (21)



Brandywine (45)



Dark Ivy (42)



### Compatible Pad Style & SnowMax Fence Style Snow Guards

**Pad Style:** PD10, PD10R, PD11, PD21, PD30, PD30Z, PD40, PD40R, PD41

**Fence Style:** SnowMax-Corrugated, SnowMax-Standing Seam,  
SnowMax-Membrane 1.5 and Solar SnowMax-Universal

### Other Pad Style Material Options

Aluminum (AL) Copper (CU) Freedom Gray™ (FG) Lead-Coated Copper (LC) Rheinzink® (ZN)

Mill Finish aluminum pad-style snow guards can also be powder coated with  
**RAL TIGER Drylac® Exterior Powder Coatings** for an additional charge.