

# Assembly Sheet - PP315 (ALL CONFIGURATIONS)

1. Installation to be completed in accordance with manufacturer's written specifications and installation instructions.
2. See spec sheet or contact manufacturer for detailed material, finishes, and configuration options.
3. Contact manufacturer for detailed layout.
4. Do not scale drawings.
5. Subject to change without notice.

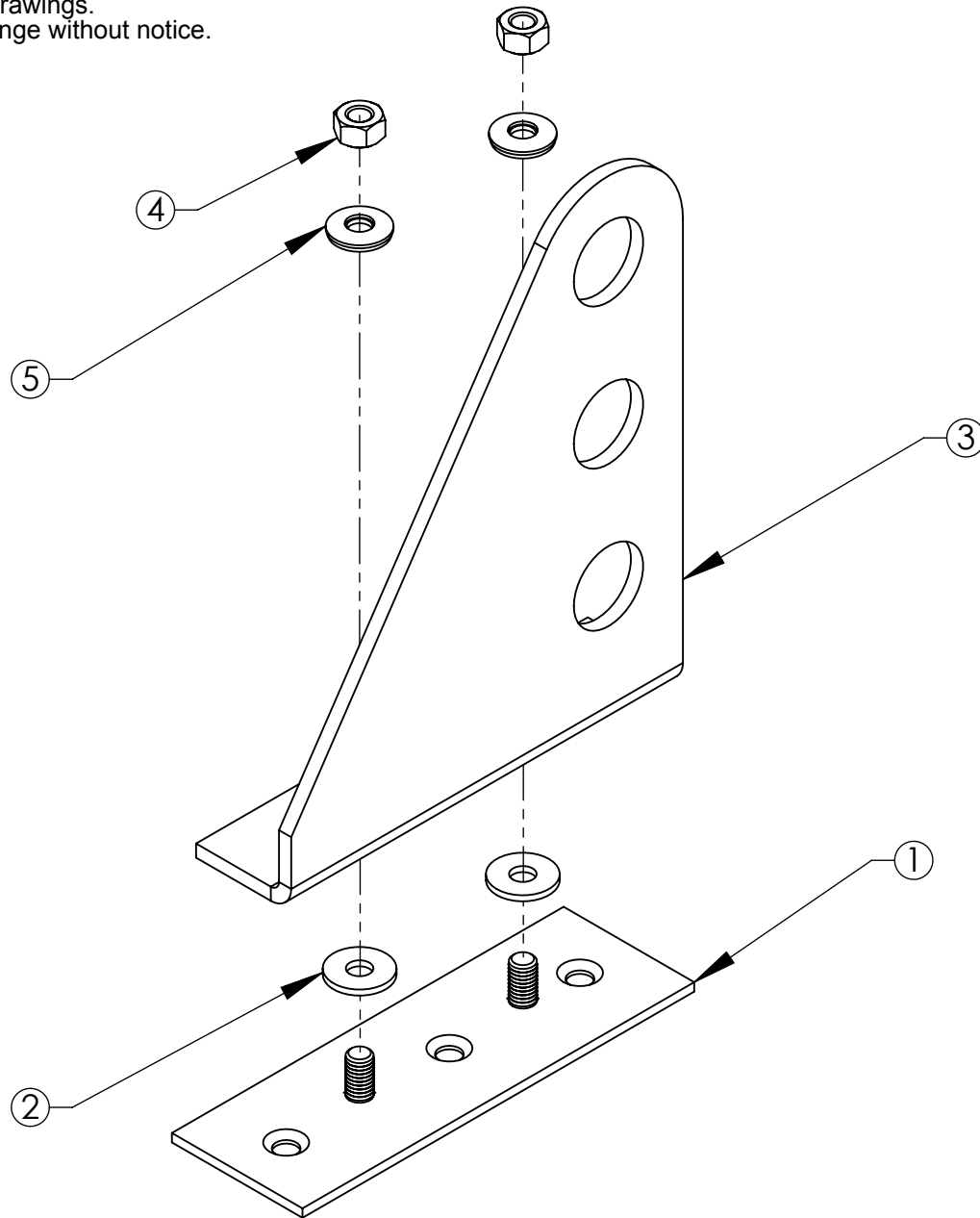

ITEM NO.	PART CODE	DESCRIPTION	QTY
1	BASE SS 2X6-200	SS 2X6-200 BASE PLATE	1
2	W-EPDM .313 QF	EPDM SEALING WASHER .313 ID (INCLUDED IN POLY KIT QF FLASHING)	2
3	PP314 BRACKET (3-PIPE SHOWN)	315 BRACKET (2-PIPE, 3-PIPE, OR HI HOLE OPTIONS)	1
4	N-HX SS-.3125-18	NUT SS HEX FINISHED .3125-18 (INCLUDED IN POLY KIT 145)	2
5	W-NEO SS-.313	SS NEO WASHER .313 ID (INCLUDED IN POLY KIT 145)	2



289 Harrel Street  
Morrisville, VT 05661  
Phone: 1.888.766.4273  
Fax: 1.888.766.9994  
Email: [Info@alpinesnowguards.com](mailto:Info@alpinesnowguards.com)

Scale: 1:2

8/20/2018