

Cut Sheet - PP315H2 6X8

1. Installation to be completed in accordance with manufacturer's written specifications and installation instructions.
2. See spec sheet or contact manufacturer for detailed material, finishes, and configuration options.
3. Contact manufacturer for detailed layout.
4. Do not scale drawings.
5. Subject to change without notice.
6. For patent information, visit our [Patent Page](#).

Available Materials

- ☐ Aluminum Bracket,
Stainless Steel Base Plate
- ☐ Brass Bracket,
Stainless Steel Base Plate
- ☐ Stainless Steel Bracket,
Stainless Steel Base Plate

Available Bracket Finishes

- ☐ Mill Finish
- ☐ Powder Coated
(Ral Tiger Drylac Powder
Coating Color Code: _____)

Available Flashing

- ☐ PP99-CU
(Copper Flashing)
- ☐ Customer Supplied

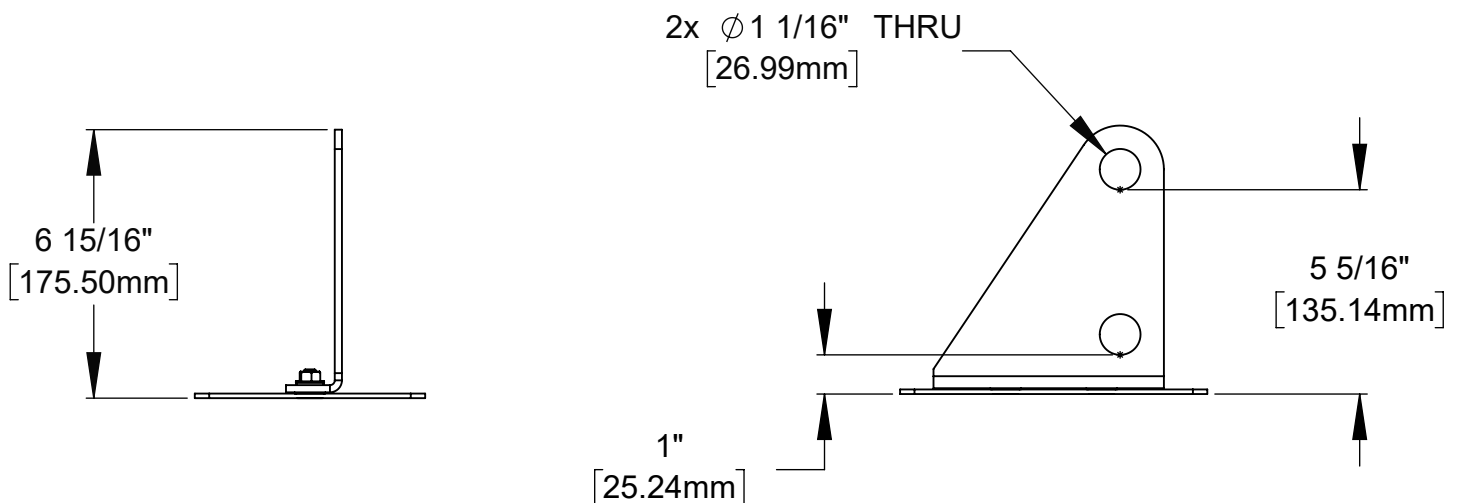
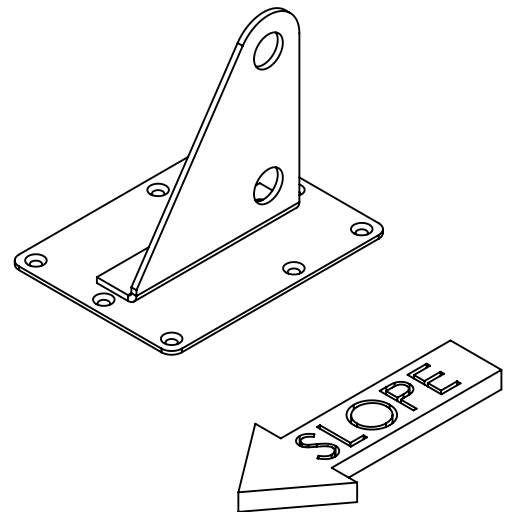
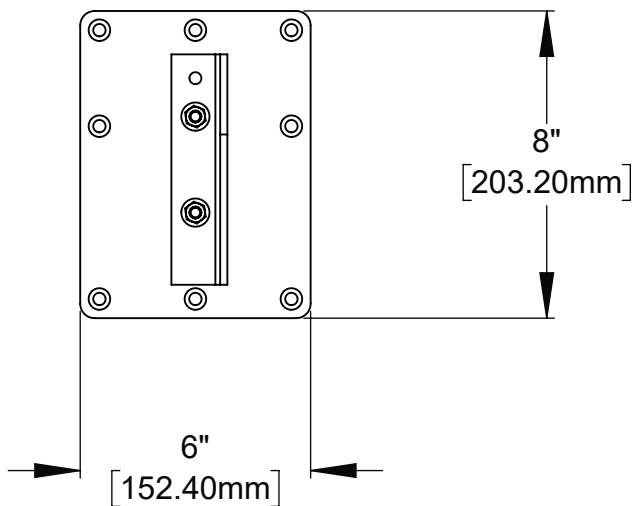

289 Harrel Street
Morrisville, VT 05661
Phone: 1.888.766.4273
Fax: 1.888.766.9994
Email: Info@alpinenowguards.com

Scale: 1:5

6/20/2022