

Cut Sheet - PP225 6X12 (ALL METALS)

1. Installation to be completed in accordance with manufacturer's written specifications and installation instructions.
2. See spec sheet or contact manufacturer for detailed material, finishes, and configuration options.
3. Contact manufacturer for detailed layout.
4. Do not scale drawings.
5. Subject to change without notice.
6. For patent information, visit our [Patent Page](#).

Available Materials

- | | |
|---|---|
| <input type="checkbox"/> Aluminum Bracket,
Stainless Steel Base | <input type="checkbox"/> Brass Bracket,
Brass Base |
| <input type="checkbox"/> Stainless Steel Bracket,
Stainless Steel Base | <input type="checkbox"/> Brass Bracket,
Stainless Steel Base |

Available Finishes

- | |
|---|
| <input type="checkbox"/> Mill Finish |
| <input type="checkbox"/> Powder Coated
(Ral Tiger Drylac Powder
Coating Color Code:_____) |

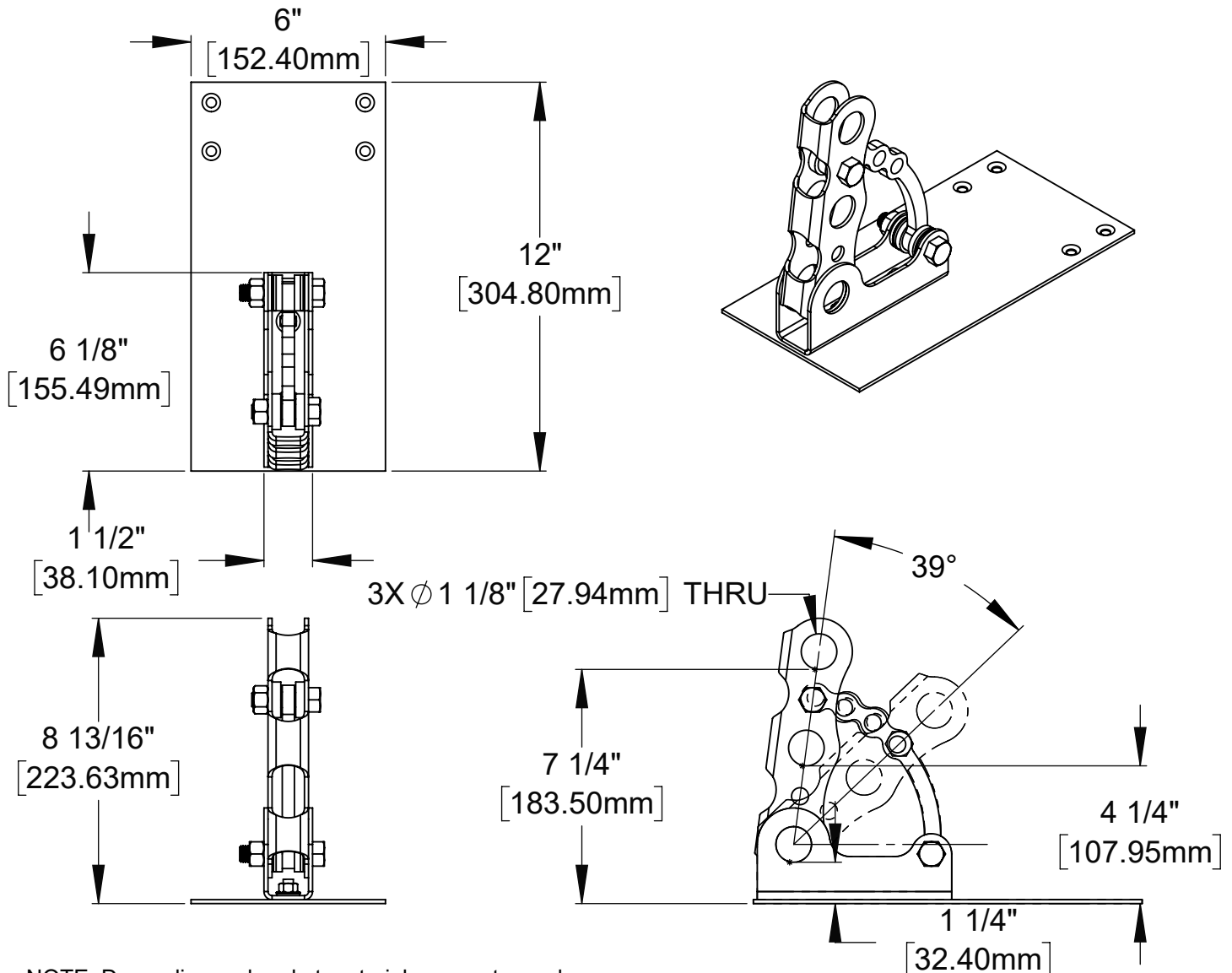

NOTE: Depending on bracket material, connector and spacer components may differ. See specific bracket assembly sheet.



289 Harrel Street
Morrisville, VT 05661
Phone: 1.888.766.4273
Fax: 1.888.766.9994
Email: Info@alpinesnowguards.com

Scale: 1:5

1/10/2023