

Assembly Sheet - PP215

1. Installation to be completed in accordance with manufacturer's written specifications and installation instructions.
2. See spec sheet or contact manufacturer for detailed material, finishes, and configuration options.
3. Contact manufacturer for detailed layout.
4. Do not scale drawings.
5. Subject to change without notice.
6. For patent information, visit our [Patent Page](#).

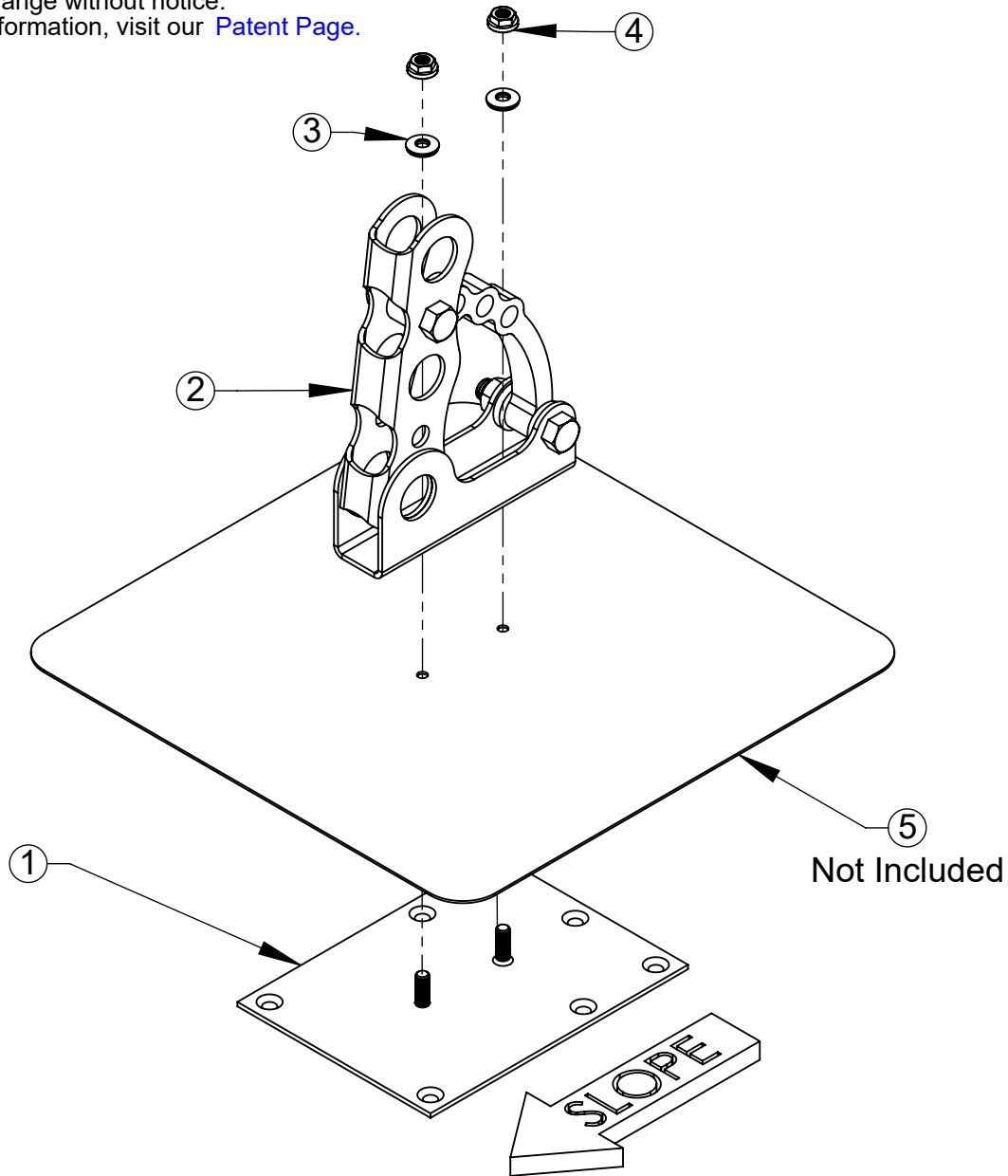

ITEM NO.	PART CODE	DESCRIPTION	QTY
1	BASE SS 6X8-200	SS 6X8-200 BASE PLATE	1
2	PP225-UPKIT	225 3PP BRACKET ONLY	1
3	W-NEO SS-.313	SS NEO WASHER .313 ID (INCLUDED IN POLY KIT GF NEO)	2
4	N-FL SS .313-18	SS FLANGE NUT .313-18	2
5	NOT INCLUDED	TARGET PATCH FLASHING (CUSTOMER SUPPLIED OR PP99-CU)	1



289 Harrel Street
 Morrisville, VT 05661
 Phone: 1.888.766.4273
 Fax: 1.888.766.9994
 Email: Info@alpinesnowguards.com

Scale: 1:4

7/26/2022