

## PD41 and PD410FCU Snow Guard Installation Instructions

### ROOF TYPES

- New / Existing Tile (Flat, Flat Tile Interlocking, Mission, Round, "S" Tile, Spanish)

### PRE-INSTALLATION

The maximum size for the PD41 is 6 1/2" (L), with a 1 1/4" hook (T) (*fig. 1*)

To determine the appropriate strap length (L), add the amount of hidden tile to 3x the thickness of the tile (*fig. 2*).

The minimum hook length (T) is 1". For thicker tiles, the hook may need to be longer than the thickness of the tile.

### INSTALLATION

1. Starting on the 3rd course of tiles, hook the snow guard over the top of the tile. Use an acceptable sealant under hook/strap to keep snow guard from shifting.

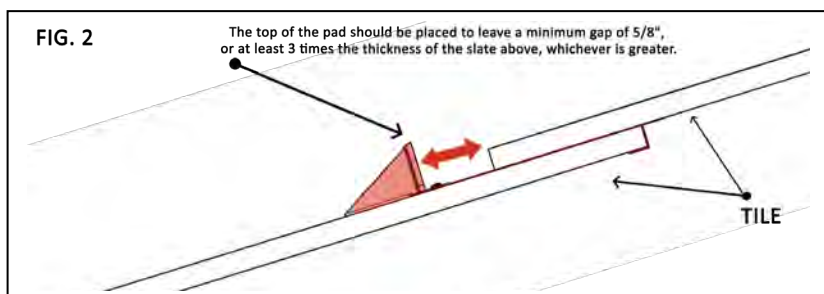

\*For projects utilizing Spanish/ Barrel tile, the snow guard should rest in the valley, as shown, as opposed to on top of the tiles rounded section.

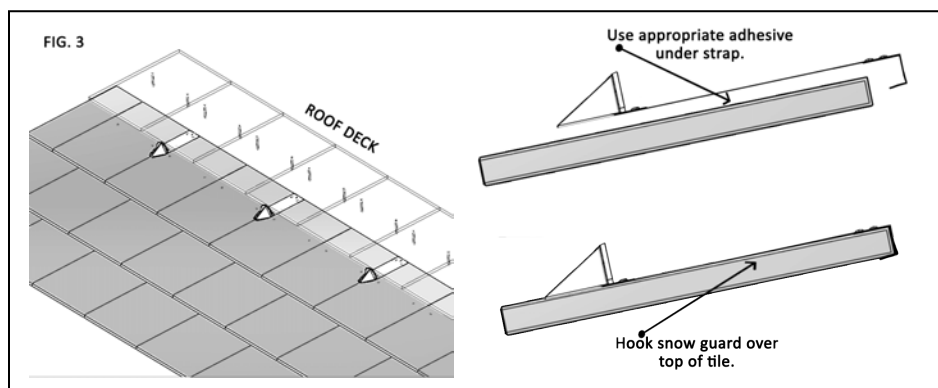
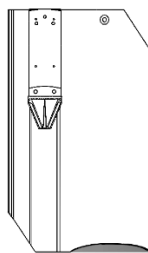

### STANDARD SNOW GUARD LAYOUT OPTIONS

**IMPORTANT:** All layouts begin with a 3-row pattern. Estimated quantities provided include 3-row pattern. If you have any questions, please contact us at 888-766-4273.

## PD41 and PD410FCU Snow Guard Installation Instructions

Please use the guidelines below to determine appropriate layout for your installation.

PAD LAYOUT GUIDELINES					
Layout	Rafter Length	Ground Snow Load (PSF)	Roof Pitch	Est. Snow Guard QTY.	Spacing
3-Row Pattern	15' or Less	60 psf or Less	16/12 or Less	17 per 10' of Eave	3 rows, 24" on center horizontally with middle row staggered 12"
2 x 4 Pattern	Greater Than 15'	60 psf or Less	16/12 or Less	12 per roofing square	Space rows 2' vertically and 4' horizontally to within 10' of the ridge.
2 x 3 Pattern	Any	61 - 90 psf	16/12 or Less	18 per roofing square	Space rows 2' vertically and 3' horizontally to within 10' of the ridge.
2 x 2 Pattern	Any	91 - 120 psf	16/12 or Less	24 per roofing square	Space rows 2' vertically and 2' horizontally to within 10' of the ridge.

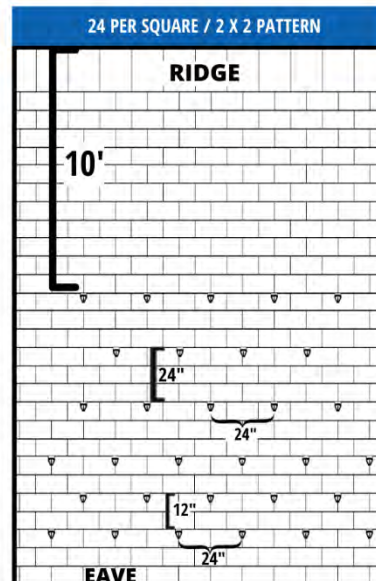
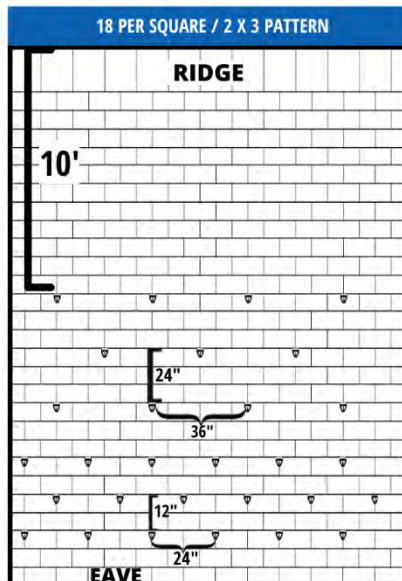
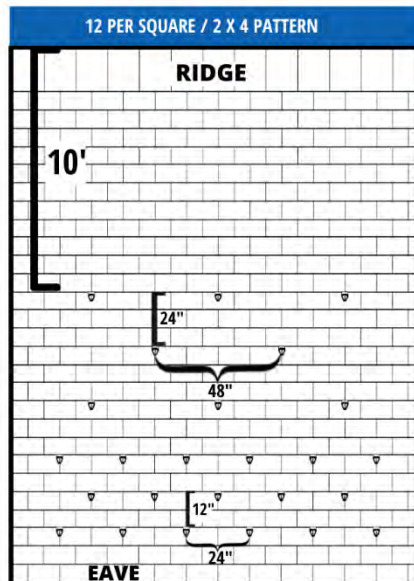
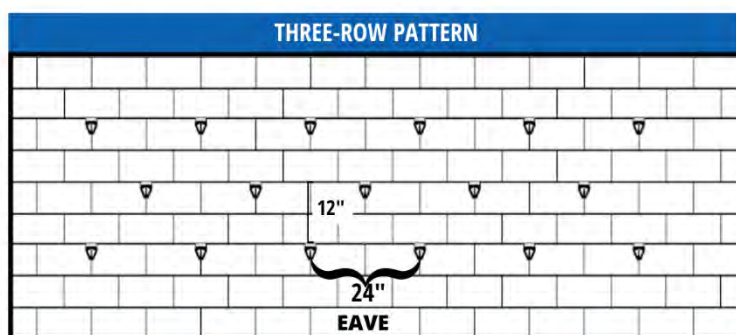

Document Version 03.14.2023  
Snow Guards 07 72 53